



Guide Price £255,000
4 TIMPSON HOUSE, STEYNE ROAD, SEAVIEW, PO34 5BH



A GREAT COMBINATION OF QUALITY, COMFORT & CONVENIENCE!

Set within a most sought after coastal setting, this delightful **GROUND FLOOR APARTMENT** is a short stroll away from Seaview village amenities, shops, eateries, Yacht Club and wonderful beaches. The accommodation, upgraded to a high standard within recent years, comprises a charming sitting room (leading to private **BALCONY** - a great spot to enjoy the pleasant garden/Solent outlook), a smart and bright modern kitchen/diner, **2 DOUBLE BEDROOMS** (both featuring built-in wardrobes), and a well proportioned bathroom. As well as some sea views, other benefits include ample storage cupboard space, double glazing throughout, modern electric radiators and neutral decor, plus the well maintained **COMMUNAL GARDENS**, parking and private **GARAGE**. Whether you are seeking a permanent residence or a holiday retreat, this apartment presents an excellent opportunity to enjoy coastal living minutes from the sea. Viewing highly recommended.

ACCOMMODATION:

Few steps up to entrance door into smart communal hallway - where there is a secure storage cupboard belonging to No. 4. Note, there is also a door to the rear of Timpson House giving level access to this floor. Private door into:

ENTRANCE HALL:

Wide carpeted hallway with cupboards x 2 (a) housing electric consumer unit and meter; (b) airing cupboard. Doors to all rooms:

SITTING ROOM:

A charming, very comfortable sitting room with double glazing sliding doors (installed in recent years) leading to **BALCONY** (with iron railings - and offering sea views). Electric slimline radiator and contemporary wall mounted fire. Carpeted flooring. Multi-paned double doors to:

KITCHEN/DINER:

A very smart modern kitchen/dining room comprising range of white cupboard and drawer units with contrasting work surfaces over incorporating inset 1.5 bowl sink unit. Integral eye level double oven and 4-ring hob. Space for tall fridge/freezer and washing machine. Ample space for dining table and chairs. Electric radiator. Wood effect vinyl flooring. Return door to Hallway. Double glazed windows x 2 to rear.

BEDROOM 1:

Carpeted double bedroom with double glazed window to front offering some sea views. Electric radiator. Excellent range of fitted wardrobes and over-bed cupboards.

BEDROOM 2:

A second carpeted double bedroom with double glazed window to front with more pleasant views. Electric radiator. Fitted double wardrobe.

BATHROOM:

Well proportioned room with modern suite comprising large corner bath with inset 'seat', shower over and shower rail/curtain; wash hand basin and w.c. Radiator. Non

slip flooring.

Tiled surrounds. Mirror fronted toiletry cabinets. Heated towel rail. Obscured double glazed window to rear.

GARDENS/BALCONY:

As well as the private **BALCONY** to front (the perfect spot to sit and enjoy the garden/Solent views), there are very well maintained communal lawned gardens with assorted mature trees - for the Timpson House and Shrewsbury Court residents to enjoy. There is a stone outhouse which houses the apartments' bins.

PARKING AND GARAGE:

Residents' parking area plus private Garage No. 4 en bloc with up and over door.

TENURE:

Long Leasehold: Balance of 999 years w.e.f. 1973.

Management Company: CCPM (Cameron Chick Property Management)

Annual Fees (to cover buildings insurance and maintenance of building and inside/outside communal areas): £1700 p.a. (plus £200 towards sinking fund)

Lease restrictions: No holiday or short term lets (6 months' plus Assured Shorthold Tenancies are permitted)

OTHER PROPERTY FACTS:

Construction: Standard

Conservation Area: No

Listed Building: No

Council Tax Band: C

Energy Performance Rating: TBC

Flood Risk: No

DISCLAIMER:

Floor plan and measurements are approximate and not to scale. We have not tested any appliances or systems, and our description should not be taken as a guarantee that these are in working order. None of these statements contained in these details are to be relied upon as statements of fact.

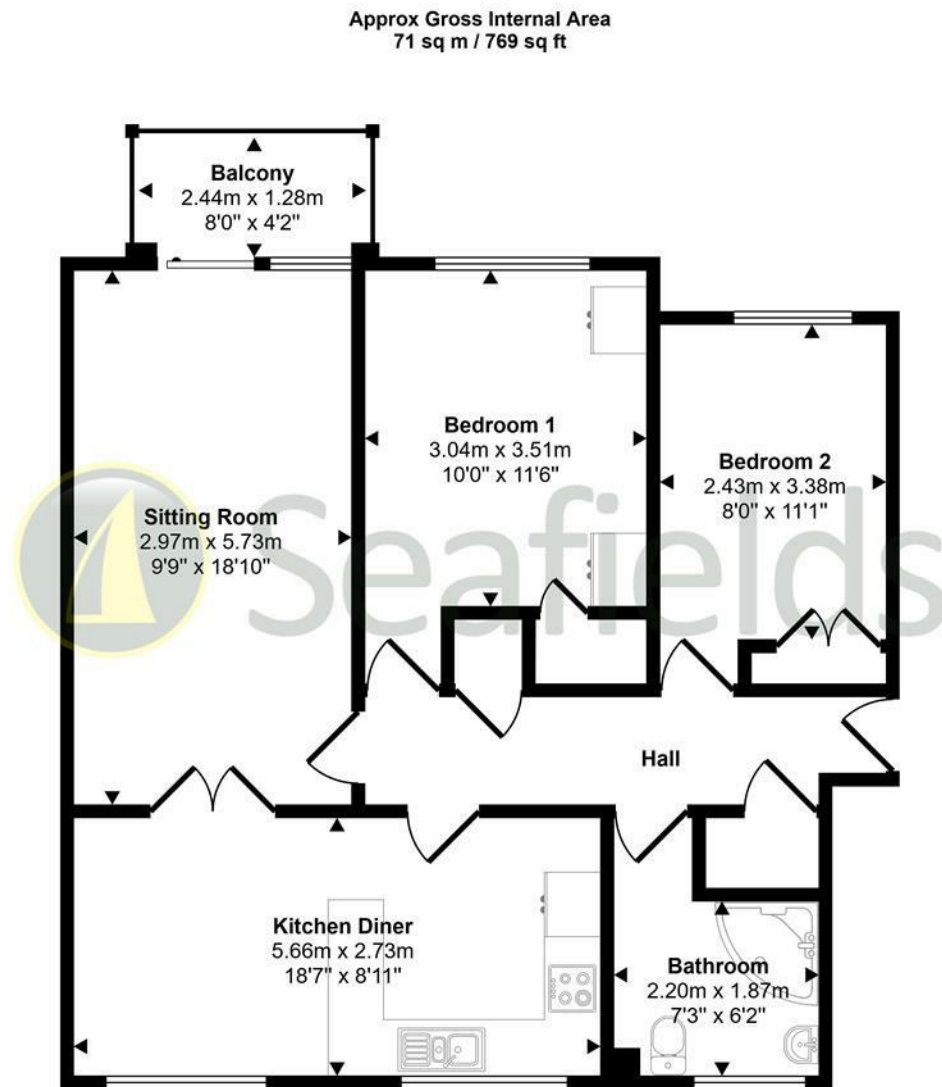

Floorplan

This floorplan is only for illustrative purposes and is not to scale. Measurements of rooms, doors, windows, and any items are approximate and no responsibility is taken for any error, omission or mis-statement. Icons of items such as bathroom suites are representations only and may not look like the real items. Made with Snappy 360.

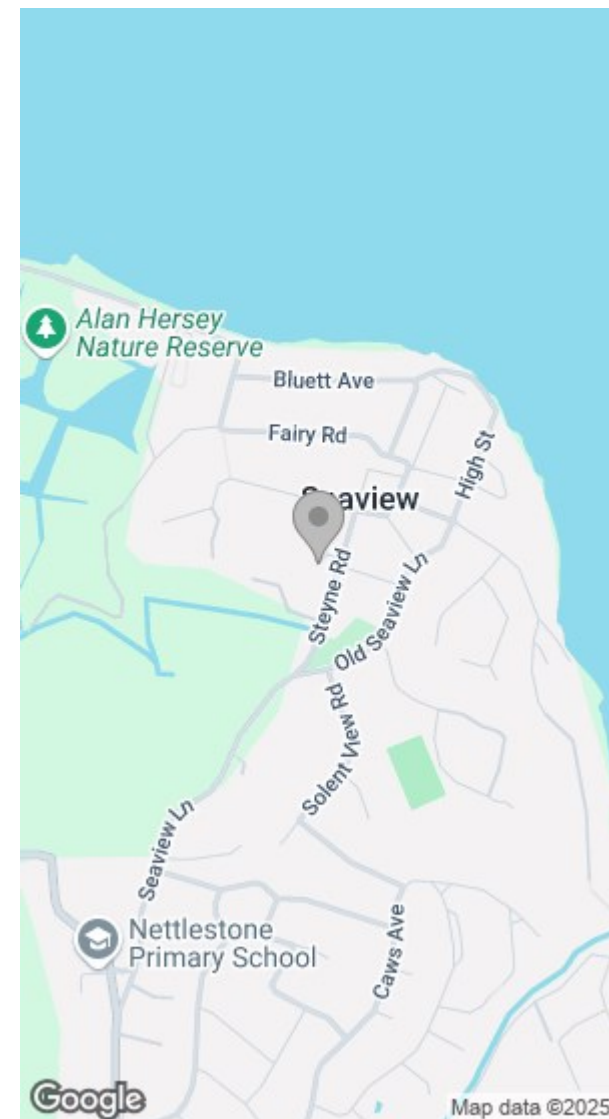

Energy Efficiency Rating			Environmental Impact (CO ₂) Rating		
	Current	Potential		Current	Potential
Very energy efficient - lower running costs			Very environmentally friendly - lower CO ₂ emissions		
(92 plus) A			(92 plus) A		
(81-91) B			(81-91) B		
(69-80) C			(69-80) C		
(55-68) D			(55-68) D		
(39-54) E			(39-54) E		
(21-38) F			(21-38) F		
(1-20) G			(1-20) G		
Not energy efficient - higher running costs			Not environmentally friendly - higher CO ₂ emissions		
England & Wales	EU Directive 2002/91/EC		England & Wales	EU Directive 2002/91/EC	

